

ROCKER
SWITCH

RL-32

RL-3 SERIES



RL-32-21-G-2-BK/BK-P5



RL-32-23-G-6-BK/BK-P5

new



RL-32-21/N-G-2-GR/BK-P5



PCV-CAP

(G) : 6 (2)A 250VAC T125/55 1E4
10A 125VAC

(H) : 10 (4)A 250VAC T125/55 1E4
10 (2)A 250VAC T85/55 5E4

16A 125V/10A 250VAC 1/3HP 125-250VAC T105

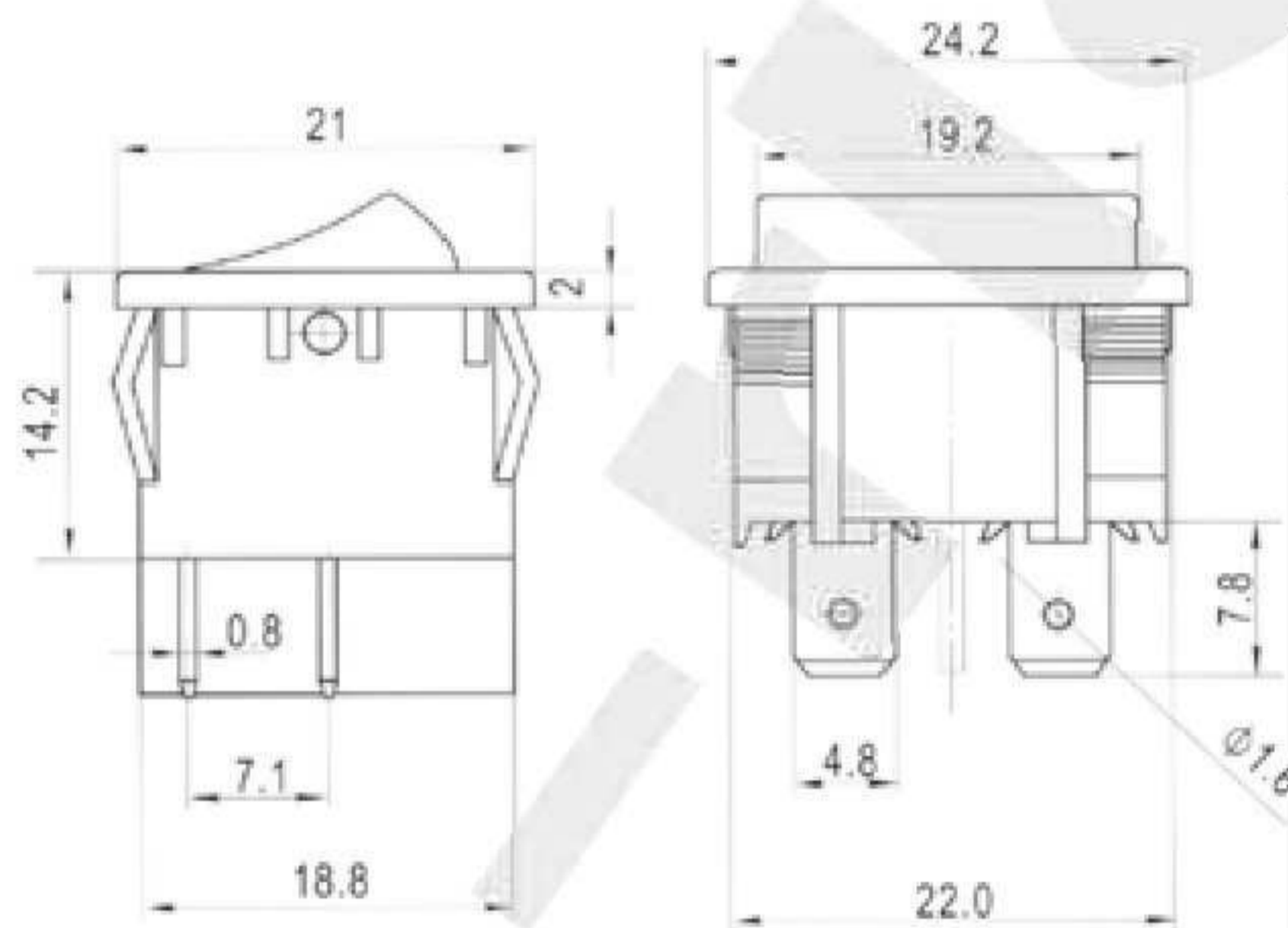
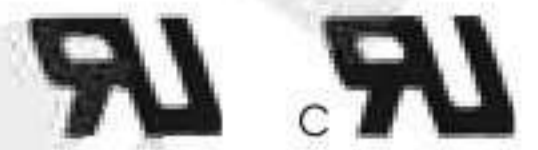

Suggested
panel hole size

Panel hole size

Panel thickness	X
0.75-1.25	19.2
1.25-2.0	19.4
2.0-3.0	19.6

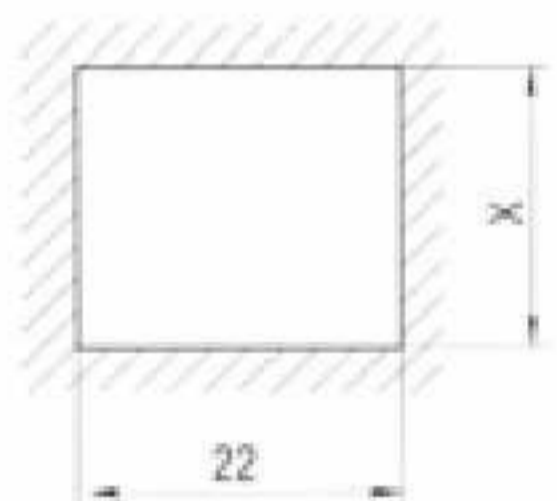

RL-32 - 21 - G - 2 - BK/BK - P5 - 0

Funtion	
21	ON - OFF 4T
22	ON - ON 6T
23	ON - OFF - ON 6T
21(ON)	(ON) - OFF 4T
21(OFF)	ON-(OFF) 4T
22(ON)	(ON) - ON 4T
21/N	ON - OFF 3T W/LAMP

Rating	
G	10A 125 VAC 6A 250 VAC
H	16A 125 VAC 10A 250 VAC

Cap Printing	
0	None
1	
2	
3	
4	
5	
8	
X	Custom.

Cap Colour / Housing	
WT	White
BK	Black
RE	Red
BL	Blue
GE	Grey

0	Nothing
P	PVC-CAP

Terminals

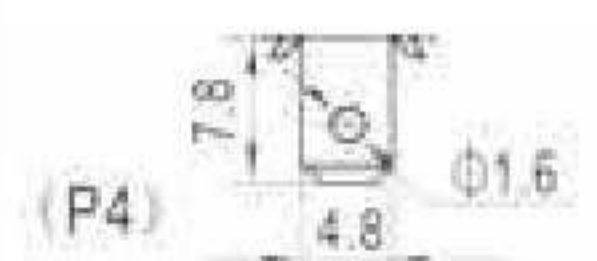

11, rue Rabelais 93102 Montreuil
Tél. : 01 49 88 28 75 Fax : 01 48 70 27 61
E-mail : info@mci-coupatan.com
Web : www.mci-coupatan.com

